



# QWARTZ 2.0

MODULABLE LED SCREEN - FINE PITCH





## OVERVIEW

Designed to get the best of both the QWARTZ and the GRANITE, the QWARTZ 2.0 is the newest addition to our indoor LED cabinet range. With fine pixel pitch, unprecedented modularity, and a competitive value for money, this product is going to be the new standard for indoor applications. Its lightweight and slim profile make this product ideal for indoor wall applications and can be integrated swiftly and with ease.



**APPLICATION**  
**Indoor**



**INGRESS PROTECTION**  
**IP30**



**PIXEL PITCH**  
**P1.9 P2.5 P2.6 P2.9**  
**P3.1 P3.9 P4.8 P5.9**



**DISPLAY AREA (W x H)**  
**250 x 500 / 250 x 750 /**  
**250 x 1000 / 500 x 500 /**  
**500 x 750 / 500 x 1000 mm**



**BRIGHTNESS**  
**≤ 800 NITS @5volts**



**WEIGHT**  
**± 22.4 kg/m²**



**MATERIAL**  
**Die-casting aluminum**



**MAINTENANCE**  
**Front maintenance**



## FEATURES

Six different cabinet sizes are available and are all compatible with one another. These cabinets can be installed both vertically and horizontally.

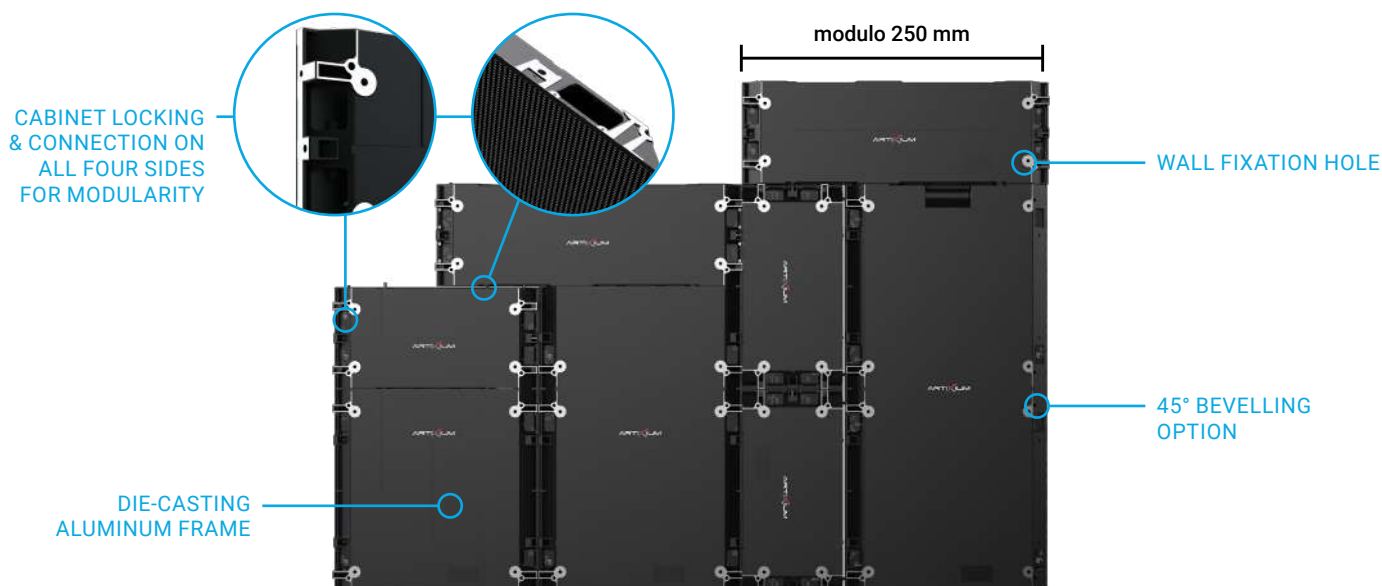

## FINE PIXEL PITCH

With fine pixel pitch ranging from P1.9 to P5.9 and Black Face SMD LEDs, the QWARTZ 2.0 can display very high-quality visual content. This feature makes

it ideal for numerous applications, such as conference rooms, briefing screens, museums, or even leisure screens, etc.



**45° BEVELLED CABINETS**

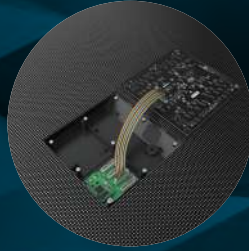

**FRONT ACCESS  
MAGNETIC MODULES**

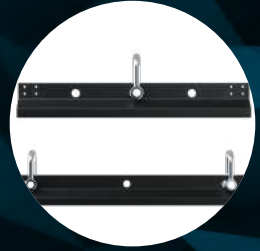

**HANGING BARS AVAILABLE**



## MODULAR APPLICATION

The QWARTZ 2.0 cabinets are available in 6 different sizes, compatible with each other, ranging from the 250 x 500 mm ribbon to the big 500 x 1000 mm cabinet. These cabinets can be integrated vertically or horizontally, and offer a wide range of possible applications. The only real limits are your project's ambition and creativity.

## 90° APPLICATIONS

All the QWARTZ 2.0 cabinets can be bevelled at 45° on the sides in order to allow perfect 90° applications. This feature even allows you to install your cabinets at a curve, given that the receiving structure is built accordingly. There also are 500 x 500 mm cabinets bevelled on all four sides, giving you the opportunity to create entire LED cubes. We implemented this feature to make sure that the QWARTZ 2.0 will fit almost any project, regardless of its complexity.





## FRONT MAINTENANCE

The QWARTZ 2.0 modules are accessible from the front thanks to their magnetic fixation. With the help of a suction tool, replacing a module, or accessing the cabinet's internal parts can be done swiftly and with ease by one technician.



## TOUCH REACTIVE OPTION

The P2.6 version of the QWARTZ 2.0 is available with SMD1010 LEDs and a touch-reactive covering, giving you the option to get a fully interactive LED screen. This option is very useful for professional use, as it allows you to conceive a tailored giant touchpad for meetings, conferences, etc.

## HIGH BRIGHTNESS OPTION

The P2.6, P2.9 & P3.1 versions of the QWARTZ 2.0 can be equipped with high-brightness LEDs (SMD1516 or SMD1921) to better suit applications where your screen might be exposed to direct sunlight. This option allows you to fit your screen in any given indoor space, notably with a lot of windows, all the while guaranteeing excellent visibility.





## FLEXIBLE MODULES

For the most creative application projects, we can provide flexible modules specially designed to fit any curve imaginable. Compatible with all QWARTZ 2.0 cabinets, these modules allow you to answer any of the most demanding tenders without changing anything to your LED screen's electrical and data configuration. We can also provide tailored backshells to ease the installation process and enhance your modules' ventilation and physical integrity.



Die-casting aluminum backshell with ventilation grids, kingpins, and wall fixation holes



Magnetic flexible modules can be curved up to 30° each (concave or convex), compatible with all QWARTZ 2.0 cabinets



## TECHNICAL SPECIFICATIONS



		INDOOR							
Product Parameters	Unit	1.9	2.5	2.6	2.9	3.1	3.9	4.8	5.9
Pixel Pitch	mm	1,95	2,50	2,60	2,98	3,13	3,91	4,81	5,95
LED		SMD1212 3in1 Black Face ( SMD1515 opt.)	SMD1515 3in1 Black Face ( SMD2020 opt.)		SMD2020 3in1 Black Face				
Application		Media (retail)							
Ingress Protection	IP	IP30							
Brightness	cd/m²	≤ 800 Nits @5volts		≤ 800 Nits @5volts (≤ 3000 Nits opt.)			≤ 800 Nits @5volts		
Color Temperature after calib (adjustable)	deg. K	6500							
Viewing Angle (50% brightness)	deg.	140 H / 140 V							
Cabinet Size (WxHxD)	mm	250 x 500 x 47 / 250 x 750 x 47 / 250 x 1000 x 47 / 500 x 500 x 47 / 500 x 750 x 47 / 500 x 1000 x 47							
Display area (WxH)	mm	250 x 500 / 250 x 750 / 250 x 1000 / 500 x 500 / 500 x 750 / 500 x 1000							
Module Size (WxHxD)	mm	250 x 250							
Pixel Matrix Per Cabinet (WxH)	px	128 x 256 / 128 x 384 / 128 x 512 / 256 x 256 / 256 x 384 / 256 x 512	100 x 200 / 100 x 300 / 100 x 400 / 200 x 200 / 200 x 300 / 200 x 400	96 x 192 / 96 x 288 / 96 x 384 / 192 x 192 / 192 x 288 / 192 x 384	84 x 168 / 84 x 252 / 84 x 336 / 168 x 168 / 168 x 252 / 168 x 336	80 x 160 / 80 x 240 / 80 x 320 / 160 x 160 / 160 x 240 / 160 x 320	64 x 128 / 64 x 192 / 64 x 256 / 128 x 128 / 128 x 192 / 128 x 256	52 x 104 / 52 x 156 / 52 x 208 / 104 x 104 / 104 x 156 / 104 x 208	42 x 84 / 42 x 126 / 42 x 168 / 84 x 84 / 84 x 126 / 84 x 168
Pixel Matrix Per Module (WxH)	px	128 x 128	100 x 100	96 x 96	84 x 84	80 x 80	64 x 64	52 x 52	42 x 42
Pixel Density	px/m²	262144	160000	147456	112896	102400	65536	43264	28224
Weight of cabinet	kg	± 22.4							
Cabinet Material		Die-casting aluminum							
Maintenance Mode		Front							
Mask specification		95% Plastic + 5% Fiber / Clips (no screws) / No shaders							
Contrast Ratio		Élevé							
Grey scale (linear)	bit	16							
Brightness control	bit	16							
Processing depth	bit	16							
Color		281 Trillions							
Display Refresh Rate	Hz	3840							
Operation Power	V	AC85-230V							
Max. Power Consumption	W/m²	420							
Average Power Consumption	W/m²	160							
Control Mode		Synchronous / Asynchronous							
Video Frame Rate	Hz	50/60Hz							
Input Types Supported		DVI / SDI / HDMI							
3D ready (optional)		Yes							
Calibration		Yes							
Lifetime (50% brightness)	h	50000							
Operating Humidity Range		10-90%							
Operating Temperature Range		0°C / +40°C							
Screen Uniformity Correction		Yes							
Certification		CE / FCC / ETL							
Available options		90° angle		Touch reactive (LED SMD1010) / High brightness LED (SMD1516) / 90° angle	High brightness LED (SMD1921) / 90° angle		90° angle		
Compatibility		All cabinet sizes are compatible with one another / A cabinet can be installed vertically or horizontally							



# TECHNICAL DRAWINGS 1/3

500 X 250 X 47 MM

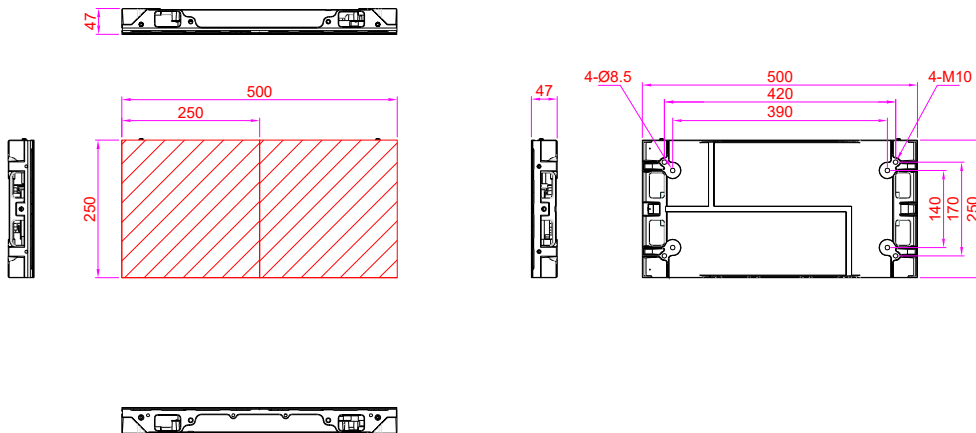

750 X 250 X 47 MM

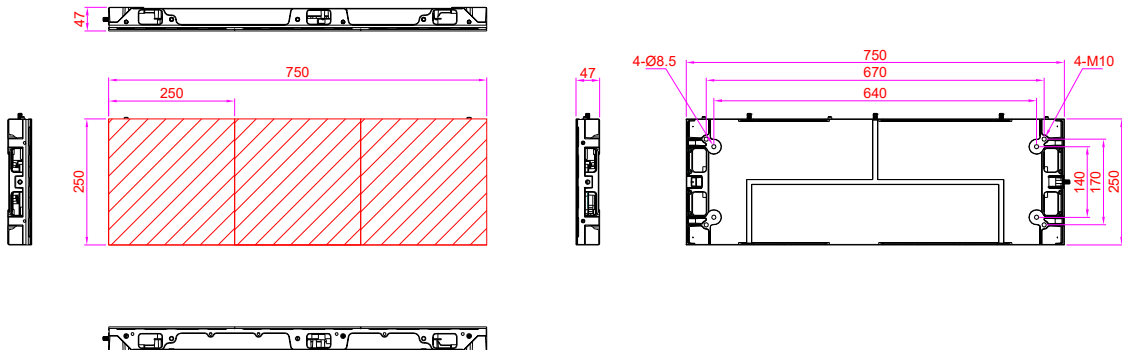

1000 X 250 X 47 MM

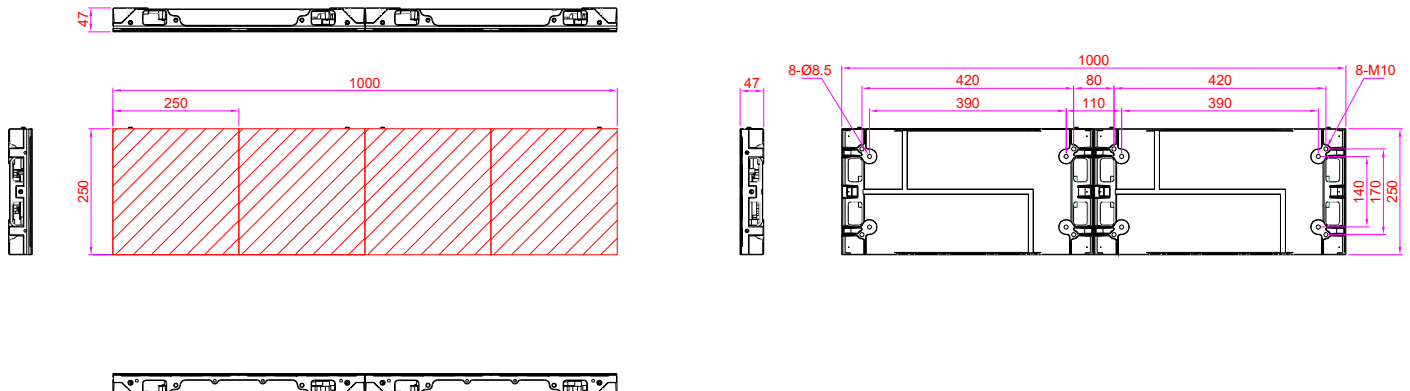



## TECHNICAL DRAWINGS 2/3

500 X 500 X 47 MM

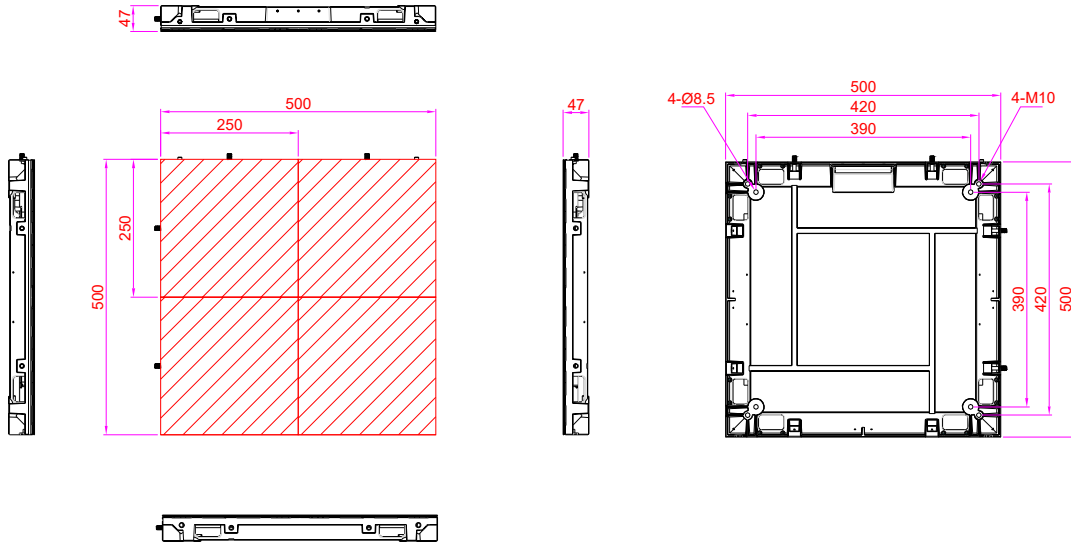

500 X 750 X 47 MM

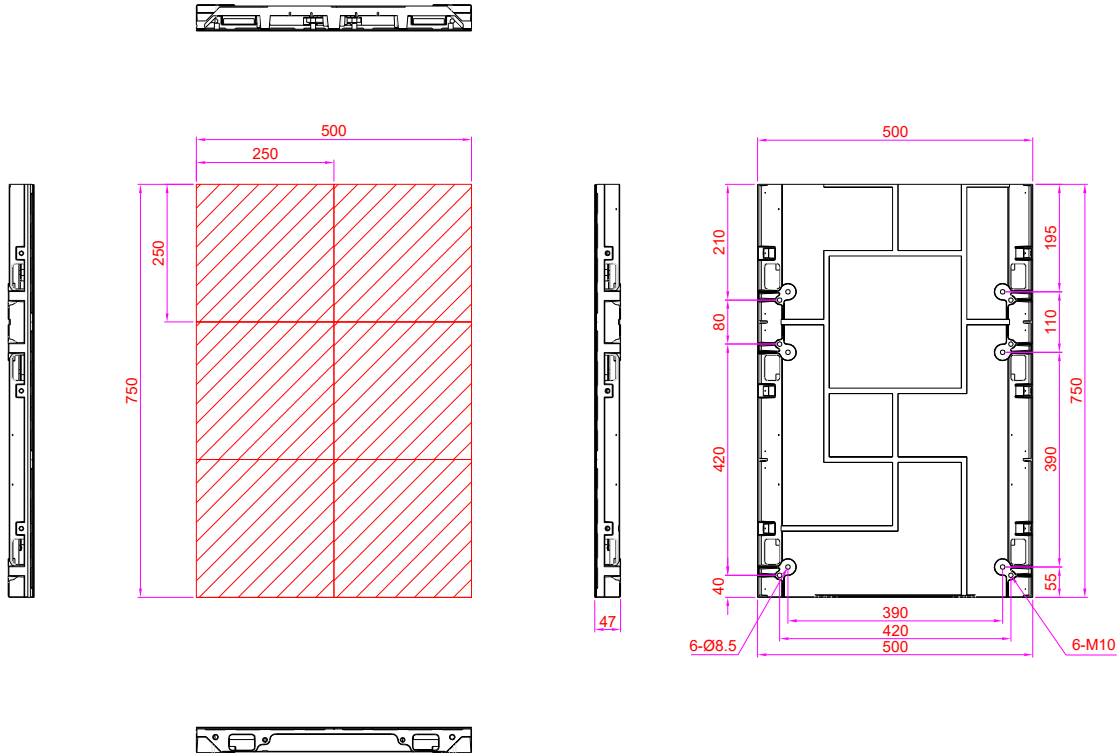





500 X 500 X 47 MM

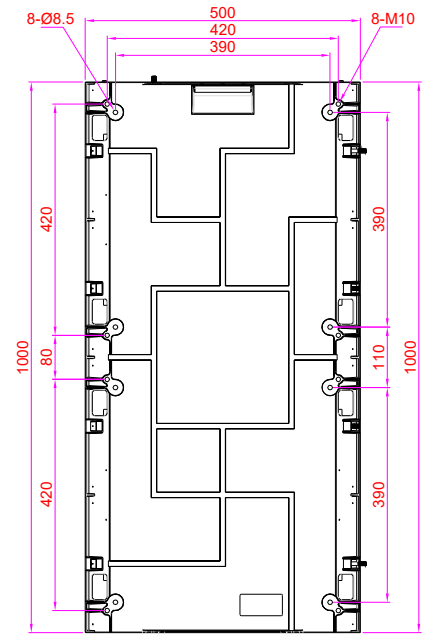
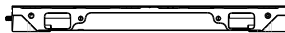
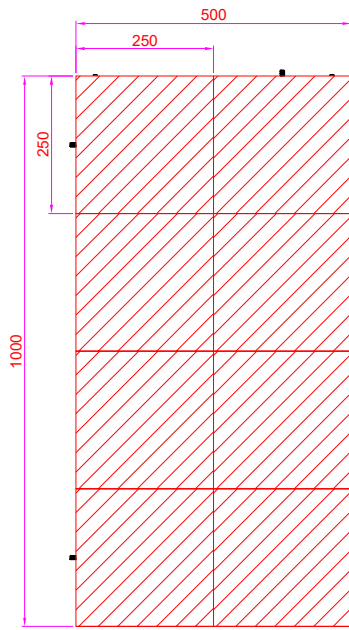

# CONTACT

The Artixium regional branches are the key for the growth and development of our global network all over the world. Artixium's team is a spectrum of different nationalities and cultures, reflecting their global presence and mindset, mak-

ing their communication smooth and hassle-free with clients from all around the world. Customer care, Innovation and flexibility has always been our values and we intend to keep this reputation for many years to come.

## ARTIXIUM FRANCHISES

*"From your project's conception to its completion."*



 112 Avenue Franklin Roosevelt  
69120 Vaulx-en-Velin  
France



 Artixium Operational Center  
518000 Shenzhen  
China



 Weissensteinstrasse 90b,  
46149 Oberhausen  
Germany



 Merkez Mah. Baglar Cad. A  
Blok Apt. No: 14D/13 Kagithane, Istanbul  
Turkey



 [www.artixium.com](http://www.artixium.com)

 0 428 001 801

 [linkedin.com/company/artixium](https://www.linkedin.com/company/artixium)

 [twitter.com/artixium](https://twitter.com/artixium)

 [contact@artixium.com](mailto:contact@artixium.com)

 [youtube.com/@artixium](https://www.youtube.com/@artixium)

 [facebook.com/artixium](https://www.facebook.com/artixium)

 [instagram.com/artixium](https://www.instagram.com/artixium)



Since its creation in 2012 by two european entrepreneurs, Artixium has been evolving and always looking for innovative ways to contribute to the digital transition of our world. It only took a few years for Artixium to become a key player in the LED display industry.

---

[www.artixium.com](http://www.artixium.com)